

# 104

1+kk  
24,9 sqm  
-1st floor



BUILDING



| Number                             | Room                         | sqm         |
|------------------------------------|------------------------------|-------------|
| 1                                  | Hallway                      | 4,1         |
| 2                                  | Bathroom                     | 3,1         |
| 3                                  | Living room + kitchen corner | 16,3        |
| <b>Usable area</b>                 |                              | <b>23,5</b> |
| Other areas, internal walls        |                              | 1,4         |
| <b>Floor area of the apartment</b> |                              | <b>24,9</b> |
| Garden                             |                              | 16,6        |
| 4                                  | Terrace                      | 3,3         |
| <b>Total floor area</b>            |                              | <b>44,8</b> |

Project Scheme

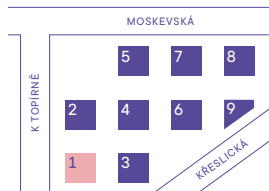

Location on floor

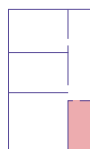

View of the House

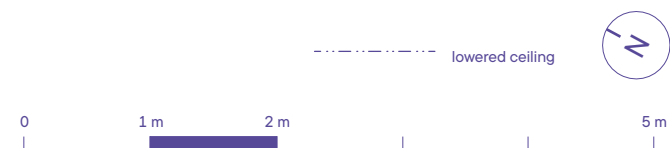
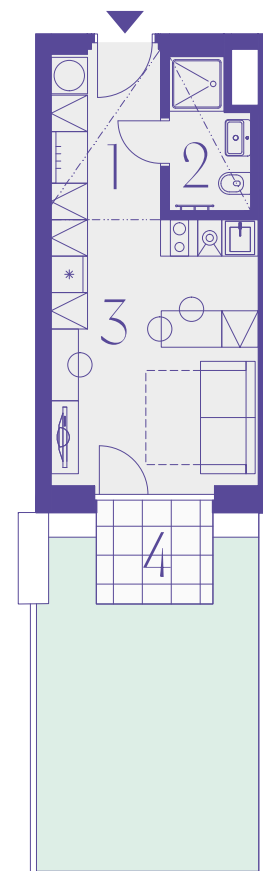
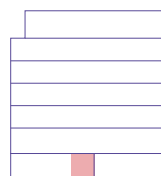

800 226 223

[CONNECTVRŠOVICE.CZ](http://CONNECTVRŠOVICE.CZ)

The room dimensions and other details listed here are approximate and non-binding. The furnishings and furniture depicted in the residential/commercial space are not included in any sale. The exact scope is specified in the sales contract. The investor reserves the right to make adjustments

