

455

4+kk
95,7 sqm
5th floor



CONNECT
VRŠOVICE



BUILDING



| Number | Room | sqm |
|------------------------------------|------------------------------|-------------|
| 1 | Hallway | 12,9 |
| 2 | WC | 1,6 |
| 3 | Bathroom | 5,3 |
| 4 | Living room + kitchen corner | 25,5 |
| 5 | Bedroom | 11,8 |
| 6 | Bedroom | 9,7 |
| 7 | Bedroom | 15,5 |
| 8 | Bathroom | 4,2 |
| 9 | Wardrobe | 3,1 |
| Usable area | | 89,6 |
| Other areas, internal walls | | 6,1 |
| Floor area of the apartment | | 95,7 |
| 10 | Balcony | 3,0 |
| Total floor area | | 98,7 |

Project Scheme

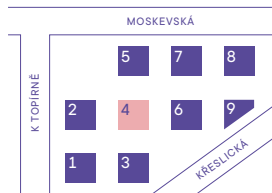

Location on floor

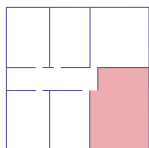

View of the House

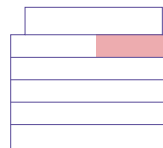

800 226 223

CONNECTVRŠOVICE.CZ

The room dimensions and other details listed here are approximate and non-binding. The furnishings and furniture depicted in the residential/commercial space are not included in any sale. The exact scope is specified in the sales contract. The investor reserves the right to make adjustments

NEOCITY
+
DARAMIS