

# 663

4+kk  
91,2 sqm  
6th floor



CONNECT  
VRŠOVICE



BUILDING



Number	Room	sqm
1	Hallway	12,8
2	WC	2,5
3	Bathroom	4,4
4	Living room + kitchen corner	28,8
5	Bedroom	9,2
6	Bedroom	9,0
7	Bedroom	14,5
8	Wardrobe	3,9
<b>Usable area</b>		<b>85,1</b>
Other areas, internal walls		6,1
<b>Floor area of the apartment</b>		<b>91,2</b>
9	Terrace	27,1
<b>Total floor area</b>		<b>118,3</b>

#### Project Scheme

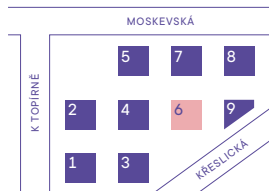

Location on floor

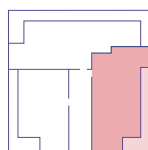

View of the House

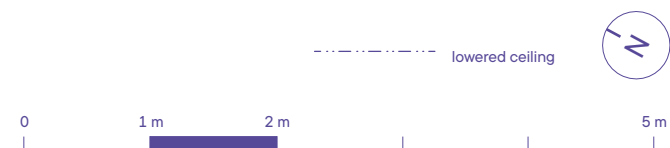
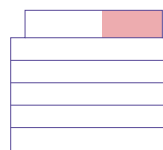

800 226 223

CONNECTVRŠOVICE.CZ

The room dimensions and other details listed here are approximate and non-binding. The furnishings and furniture depicted in the residential/commercial space are not included in any sale. The exact scope is specified in the sales contract. The investor reserves the right to make adjustments

NEOCITY  
+  
DARAMIS